

4

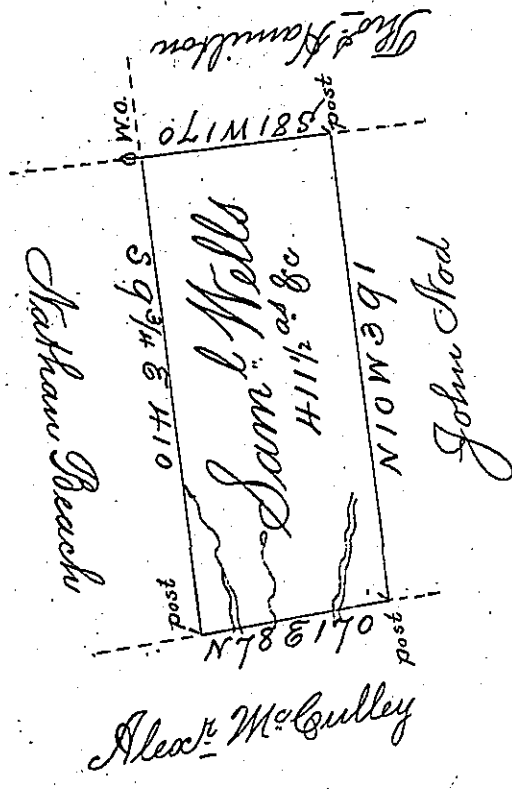

A Draft of a tract of land Called \_\_\_\_\_  
 Situate on the North side of the Neseopeek Mountain in  
 Catawispsey Township Northham<sup>d</sup> County Containing four  
 hundred & Eleven acres 1/2 & allor<sup>e</sup> Surveyed for Samuel  
 Well the 6<sup>th</sup> day of August 1794 by Virtue of a Warrant  
 dated the 7<sup>th</sup> day of Dec<sup>r</sup> 1793

Daniel Brodhead Esq<sup>r</sup> }  
 Swor<sup>e</sup> Gen<sup>l</sup> } by Wm Gray of

IN TESTIMONY that the above is a copy of the original remaining on file in  
 the Department of Internal Affairs of Pennsylvania, made  
 conformably to an Act of Assembly approved the 16th day of  
 February, 1833, I have hereunto set my Hand and caused  
 the Seal of said Department to be affixed at Harrisburg,  
 this sixth day of May 1902

James W. Latta  
 Secretary of Internal Affairs.